

CONTROLLING a BRYSTON SST POWER AMPLIFIER with a BP20/25 PRE-AMPLIFIER

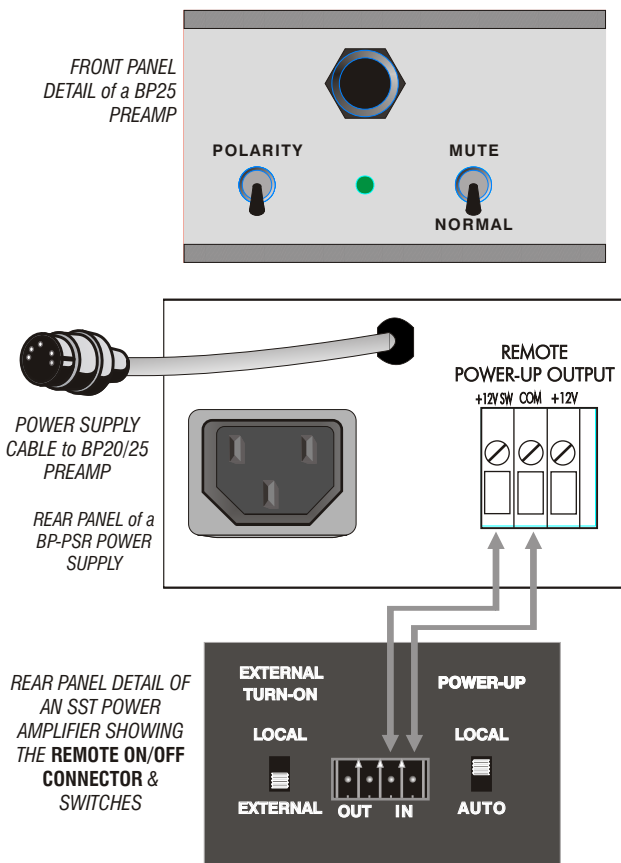

When the BP-PSR power supply is connected to a Bryston SST amplifier as shown above, the SST power amplifier is powered down when the BP20/25 preamp is MUTED (either by the preamp toggle switch or by infra-red handheld remote MUTE button). When the preamp MUTE is released the power amplifier will be once again powered up. The BP-PSR power supply's front panel power (slide) switch must be turned ON for this mode to function.

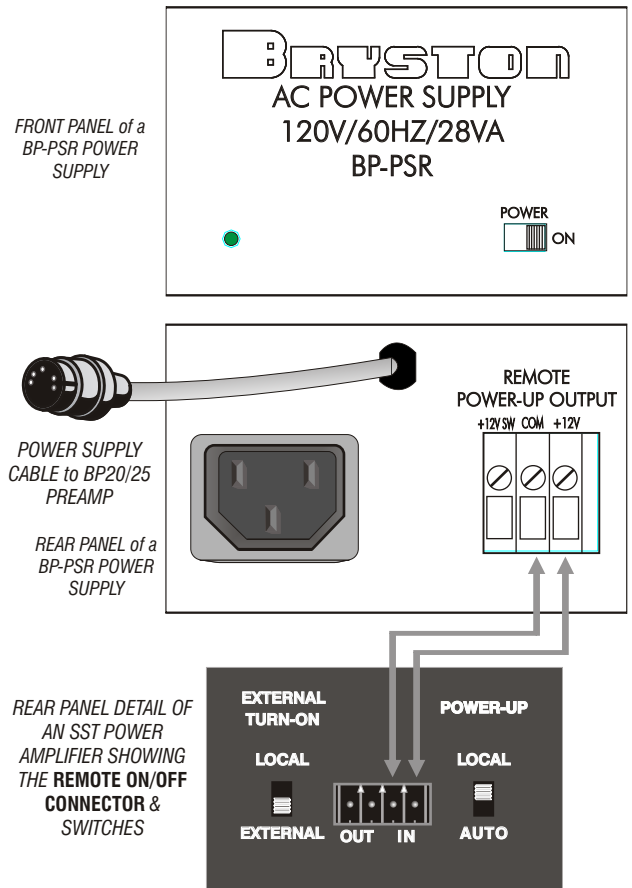

When the BP-PSR power supply is connected to a Bryston SST amplifier as shown above, the BP20/25 preamp and the SST power amplifier are both controlled (i.e. powered up or down) by the BP-PSR power supply's On/Off (slide) switch, located on its the front panel of the BP-PSR

PLUG-IN SCREW TERMINAL CONNECTOR

Bryston SST amplifiers are supplied with a plug-in terminal block, as shown below, that plugs into the amplifiers *Remote On/Off Connector*. Insert stripped and twisted wires into the openings of the wire-clamp connector and tighten with a slot screw driver. Do not over tighten as this may cause the wires to eventually come loose. Maximum tightening torque is 4.5 lb-in (0.5Nm)

